

Mosaic™
LCS² Cat. 5e RJ 45 socket

Cat. no(s): 765 01/02/41/42/51/52/54/55/97/98
794 51/52/54/55

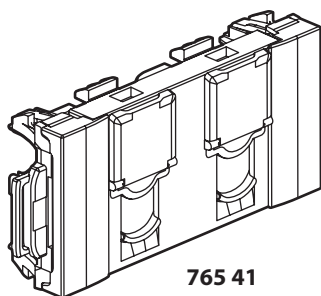

765 41

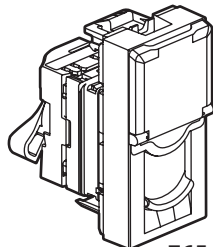

765 51

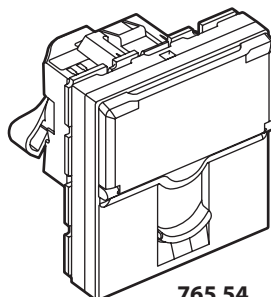

765 54

CONTENTS

Page

1. General characteristics	1
2. Presentation	1
3. Real life scenarios	1
4. Technical features	1
5. Installation	2
6. Overall dimensions	2
7. Standard RJ 45 connections	2
8. Performance	3
9. Standards and approvals	4

1. GENERAL CHARACTERISTICS

Category 5e RJ 45 socket. Allows high-speed transmissions (Gigabit Ethernet).

	Designation	No. of modules	UTP	FTP	Weight (g)
	RJ 45 socket, Cat. 5e UTP	1	765 51		13
	RJ 45 socket, Cat. 5e UTP aluminium	1	794 51		13
	RJ 45 socket, Cat. 5e FTP	1		765 52	13
	RJ 45 socket, Cat. 5e FTP aluminium			794 52	13
	RJ 45 socket, Cat. 5e UTP	2	765 54		18
	RJ 45 socket, Cat. 5e UTP aluminium	2	794 54		18
	RJ 45 socket, Cat. 5e FTP	2		765 55	18
	RJ 45 socket, Cat. 5e FTP aluminium	2		794 55	18
	2 x RJ 45 socket Cat. 5e UTP	4	765 41		
	2 x RJ 45 socket Cat. 5e FTP	4		765 42	
	RJ 45 safety socket Cat. 5e UTP	2	765 97		
	RJ 45 safety socket Cat. 5e FTP	2		765 98	
	RJ 45 socket 45° cat. 5e UTP	2	765 01		13
	2 x RJ 45 socket 45° cat. 5e UTP	2	765 02		34

2. PRESENTATION

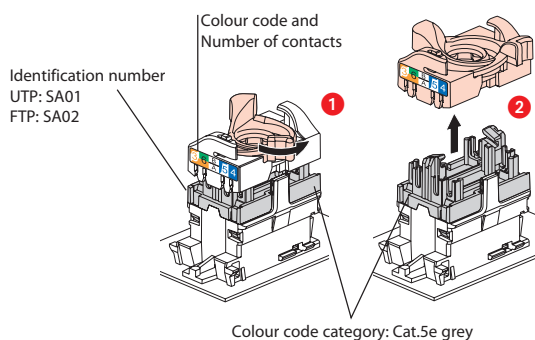

3. REAL LIFE SCENARIOS

Mechanisms can be flush-mounted or surface-mounted.

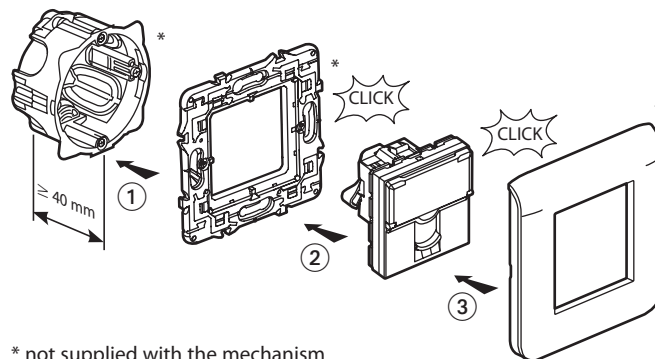

Mounting on a modular support can be carried out using a Cat. No. 802 99 adapter (2 modules).
Mechanisms are mounted on thin walls with the following adaptors: Cat. No. 802 90 (1 module), Cat. No. 802 91 (2 modules), Cat. No. 802 92 (vertical 2 x 1 module).

Cat. No. 765 97/98

Unlocking

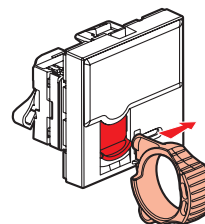

334 80

4. TECHNICAL FEATURES

4.1 Characteristics of the materials

Contacts : gold/nickel, thickness of gold >0.8 μm minimum
Metal parts: bronze, nickel, platinum, gold
Polycarbonate PBT

4.2 Electrical characteristics

Breakdown voltage ≥ 1000 V
Contact resistance ≤ 20 mΩ
Insulation resistance ≥ 500 MΩ under 100 V DC
Performance of resistance to a POE signal up to 50 W

4.3 Mechanical characteristics

Max. number of connections/ disconnections: 5 without re-preparing the wire
Endurance: 2500 operations (mating/extraction)
IK03

4.4 Climatic characteristics

Operating temperatures: -40°C to +70°C
Humid heat 21-day cycle

5. INSTALLATION

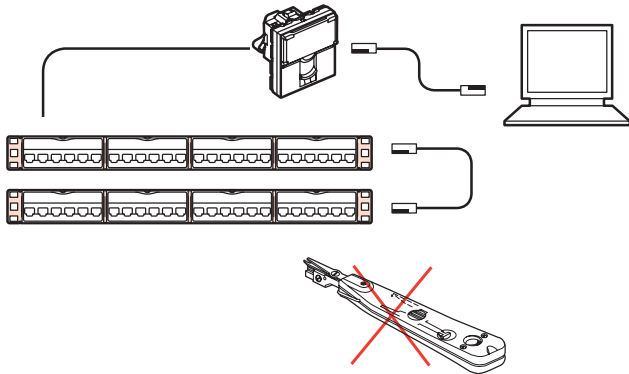

6. OVERALL DIMENSIONS

Front view :

765 54/55/97/98 - 794 54/55

765 51/52 - 794 51/52

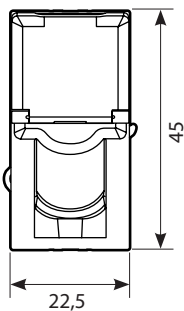
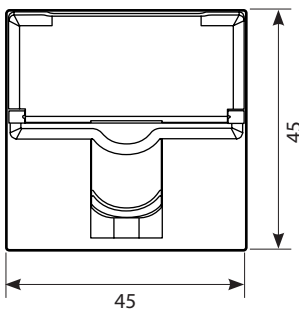

765 01

765 02

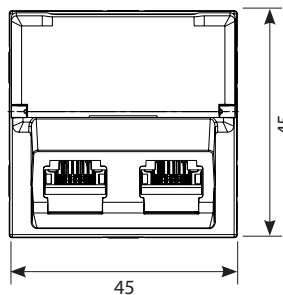
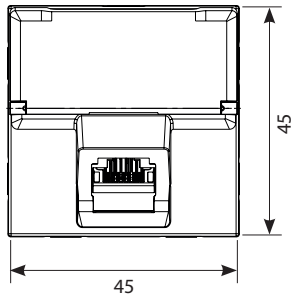

765 41/42

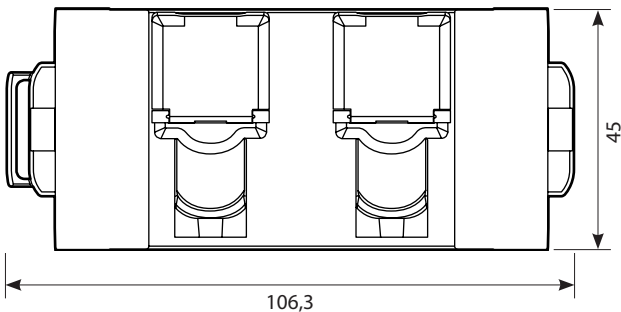

Side view

765 01/02

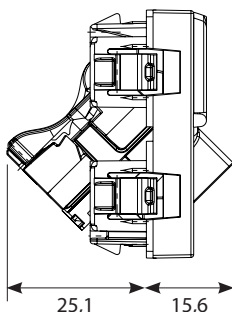
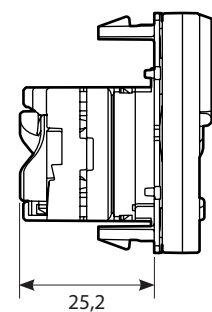

7. STANDARD RJ 45 CONNECTION

Takes the following plugs:

RJ 11 (4 contacts), RJ 12 (6 contacts), RJ 45 (9 contacts).

EIA/TIA 568 A and B dual colour code on terminals:

- UTP 8 contacts
- FTP 9 contacts

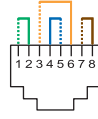

EIA 568 A



EIA 568 B

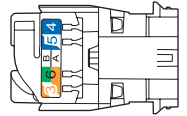
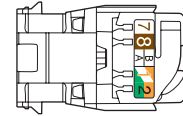

Permitted conductors:

- Single-core: 0.5 to 0.65 mm, AWG 22 to 25
- Multicore: AWG 26
- Polyethylene conductor insulation: Ø max. on 1.58 mm insulation

Number of wires to be connected per connection: 1

RJ 45 connectors are equipped with a locking nut. They do not require a special tool and can be re-wired if a mistake is made.

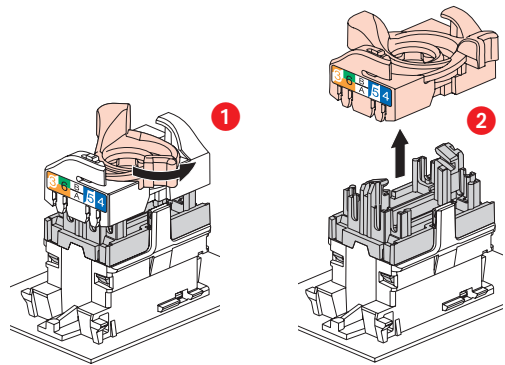

This system allows you to spread pairs with ease before fitting them onto the connector.

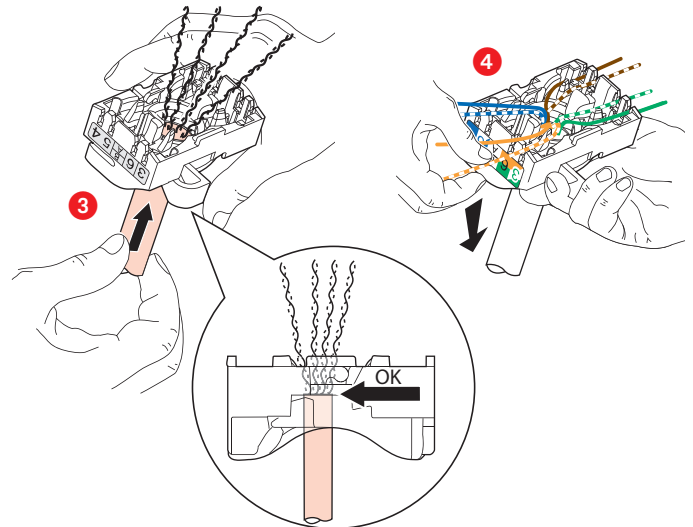

Spreading the cables allows you to ensure that a pair-breakage distance of 13 mm is kept between each pair.

Spreading pairs at 90° to the cable ensures the best possible performance.

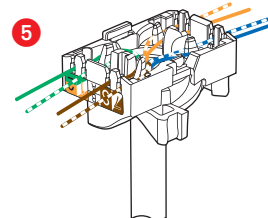

8. PERFORMANCE

8.1 Performance of components (RJ 45 connectors)

Return loss

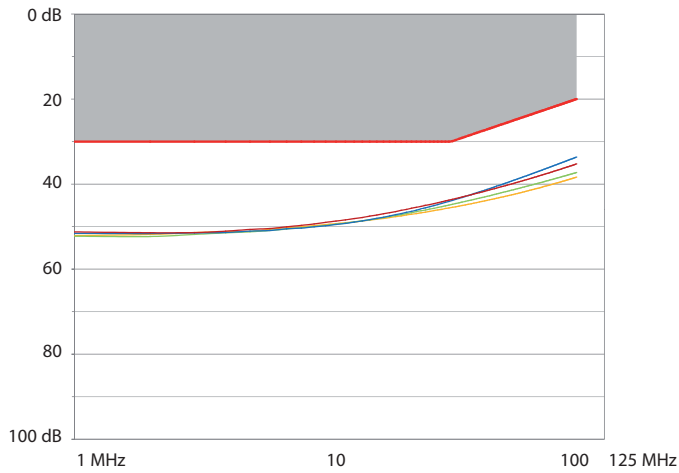

Attenuation

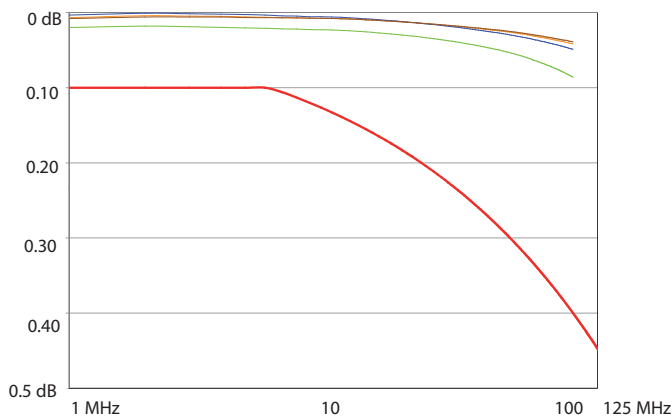

NEXT (Near end Crosstalk Attenuation)

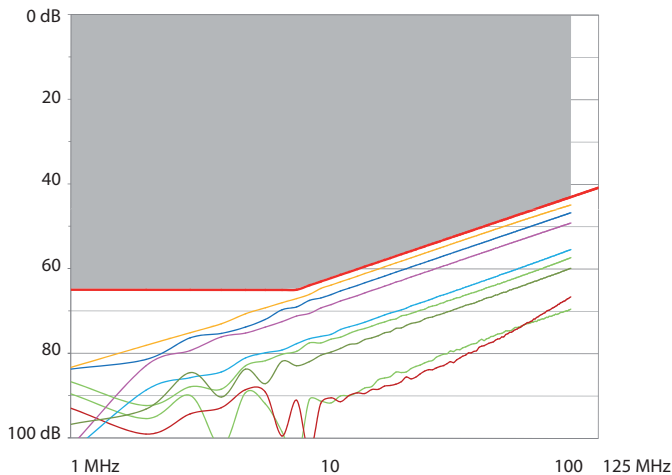

8. PERFORMANCE (continued)

8.1 Performance of components (RJ 45 connectors) (continued)

FEXT (Far end Crosstalk Attenuation)

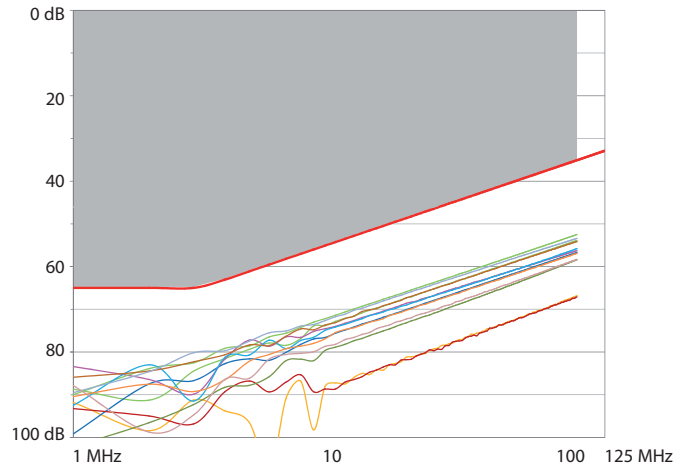

8.2 Performance of permanent link with F/UTP cable

Return loss

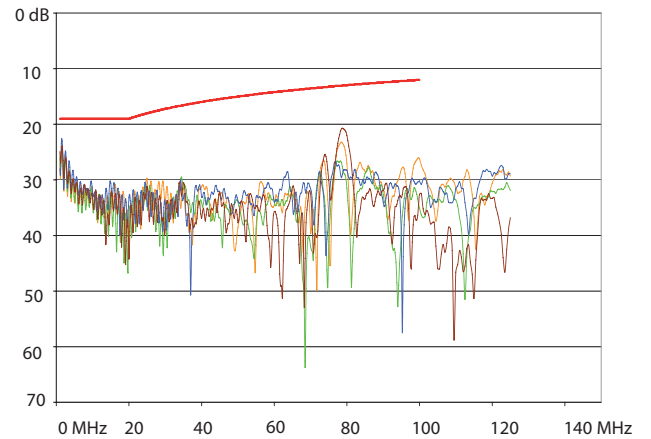

Attenuation

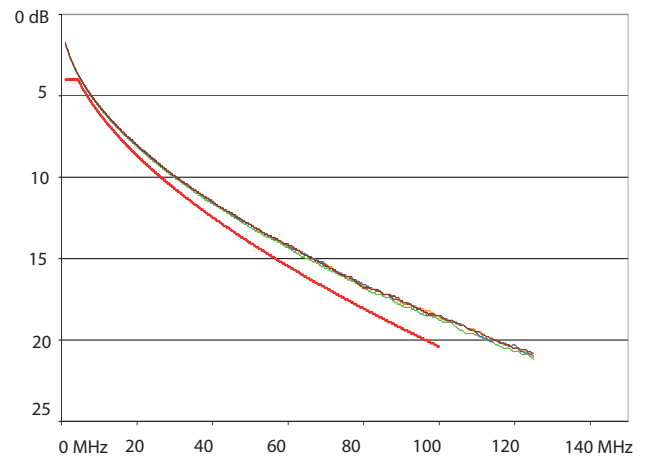

8. PERFORMANCE (continued)

8.2 Performance of permanent link with F/UTP cable (continued)
 NEXT (Near end Crosstalk Attenuation)

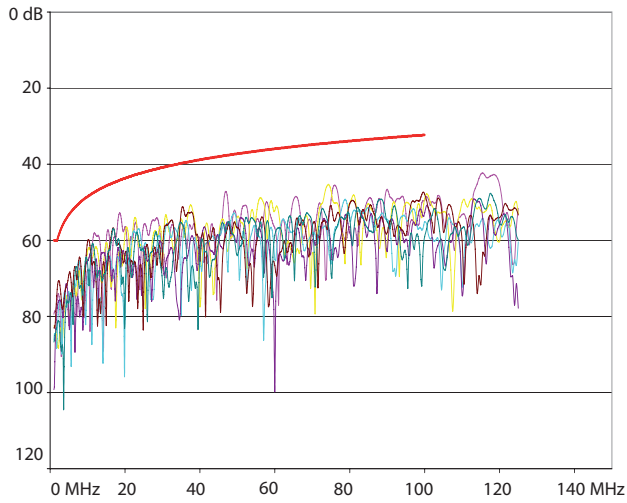

PS NEXT (Power Sum NEXT)

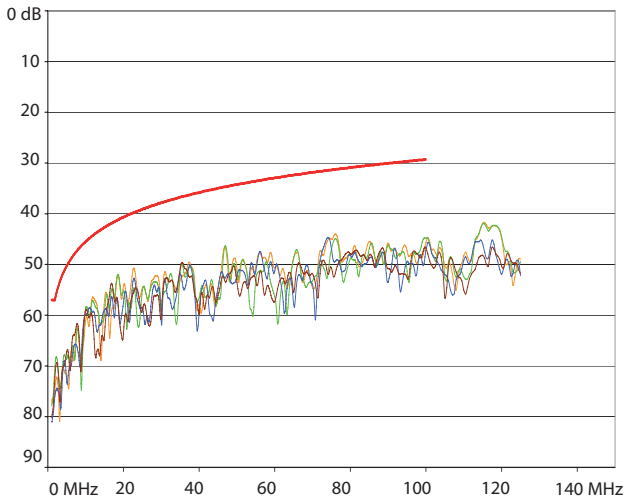

ACR (Attenuation to Crosstalk Ratio)

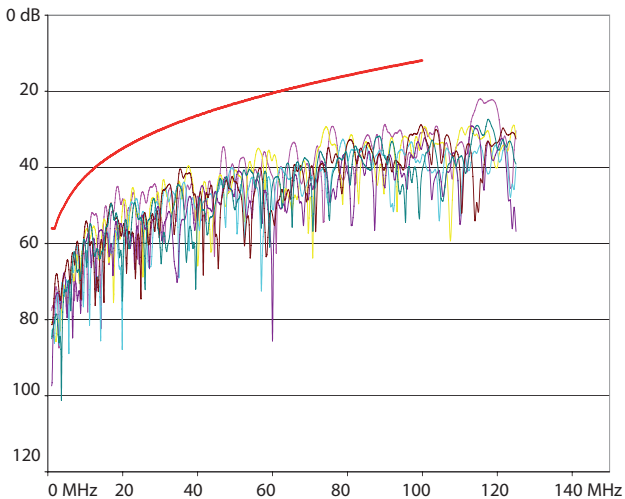

8. PERFORMANCE (continued)

8.2 Performance of permanent link with F/UTP cable (continued)
 ELFEXT (Equal Level Far End Crosstalk Attenuation)

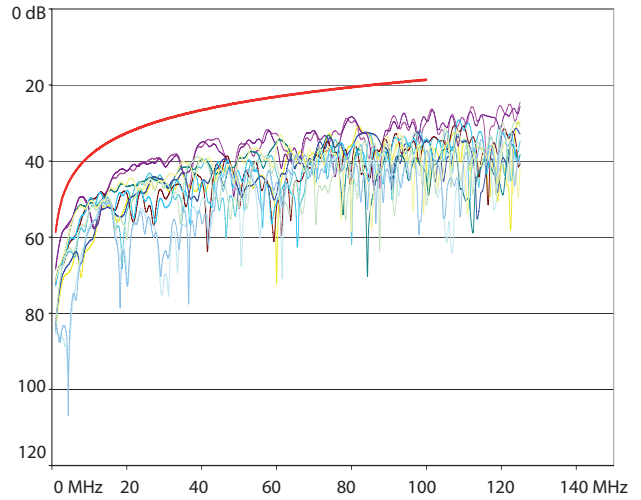

9. STANDARDS AND APPROVALS

Conforms to standards: ISO/IEC 11801 Ed2 and Amd.
 CENELEC EN 50173-1 2007
 ANSI/EIA/TIA 568-C.2
 IEC 60603-7 series